

SCHEMATIC DIAGRAM STA-200 (31-2050)

PRESETTER UNIT

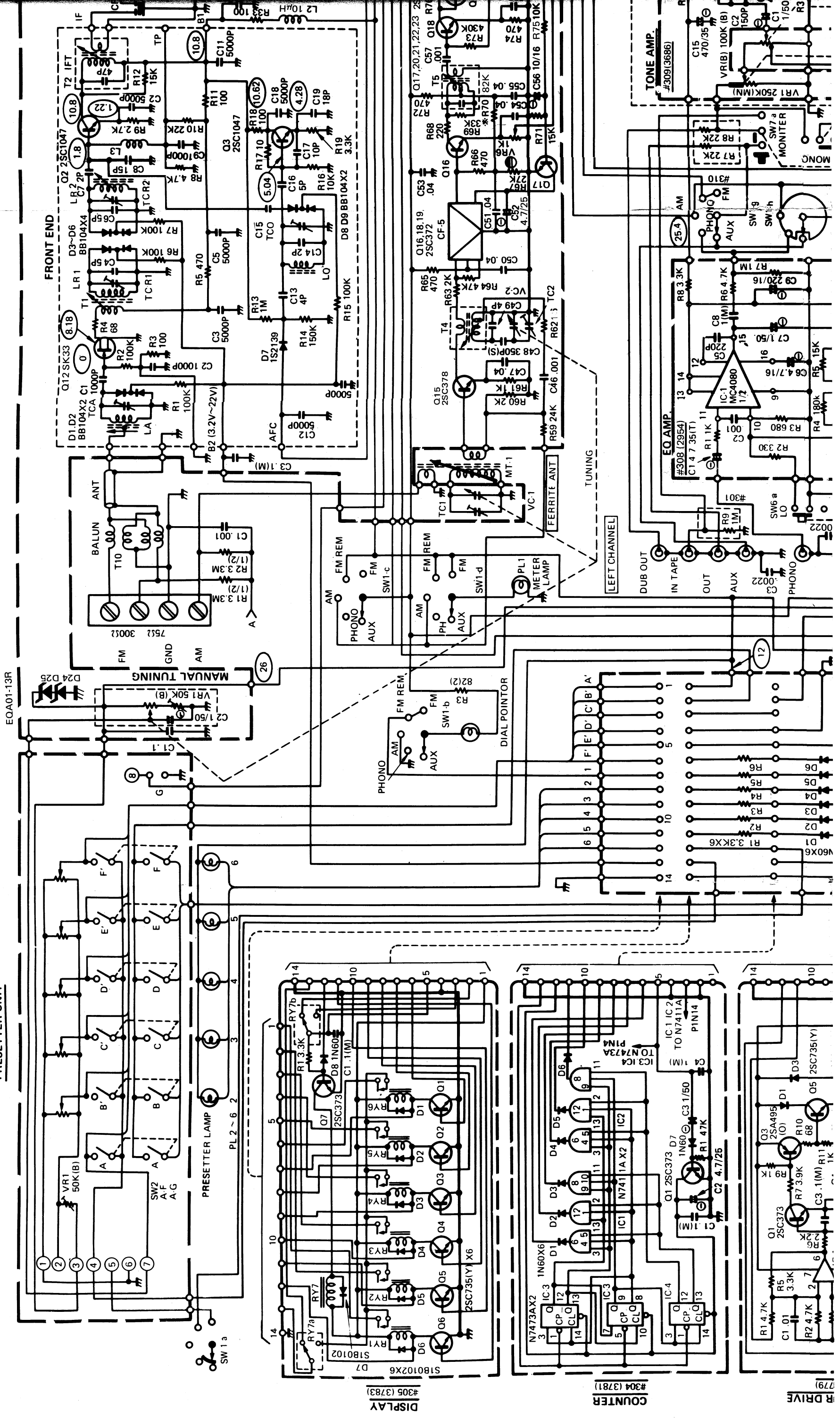

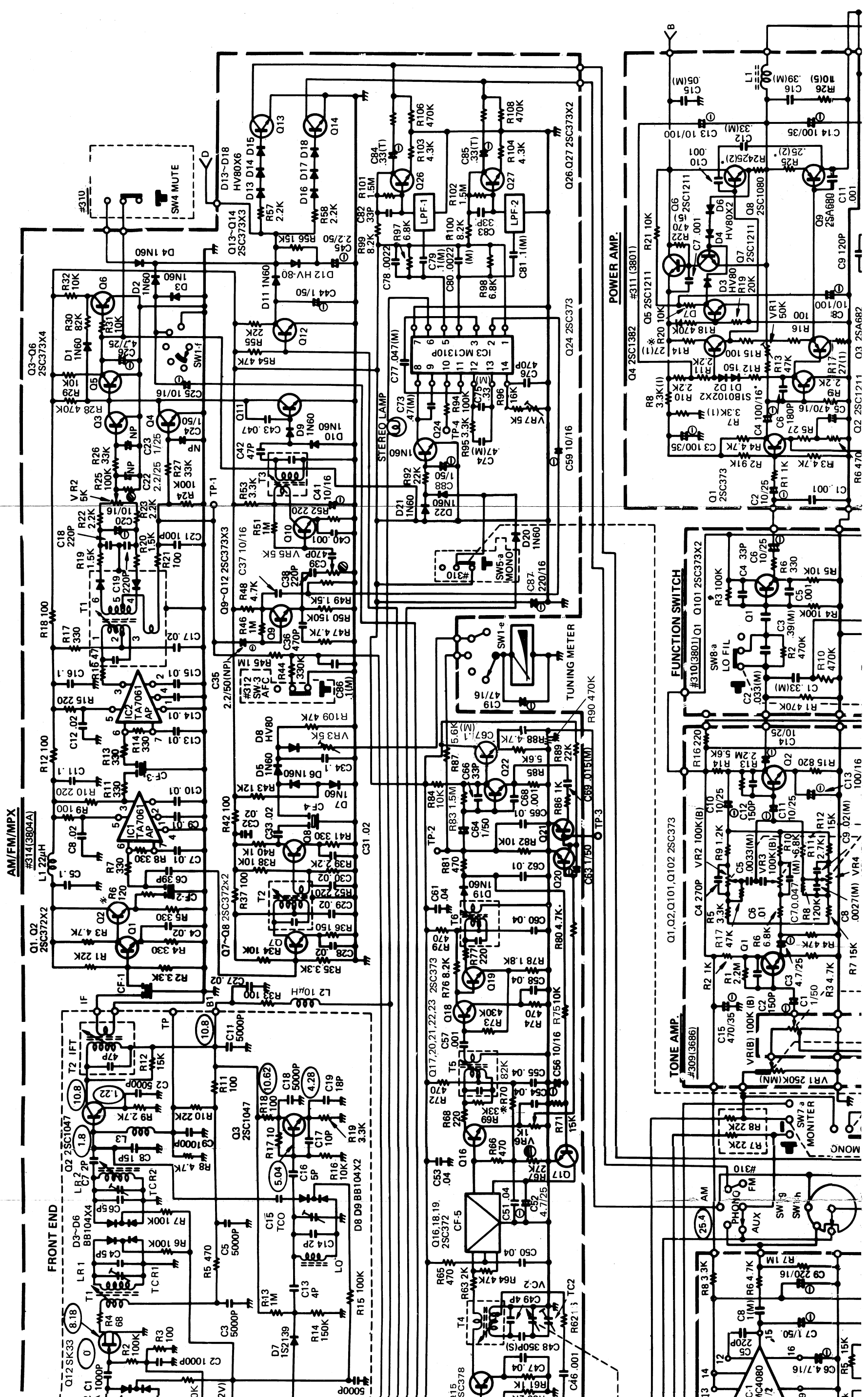

AM/FM/MPX

FRONT END

STEREO LAMP

TUNING METER

FUNCTION SWITCH

TONE AMP.

POWER AMP.

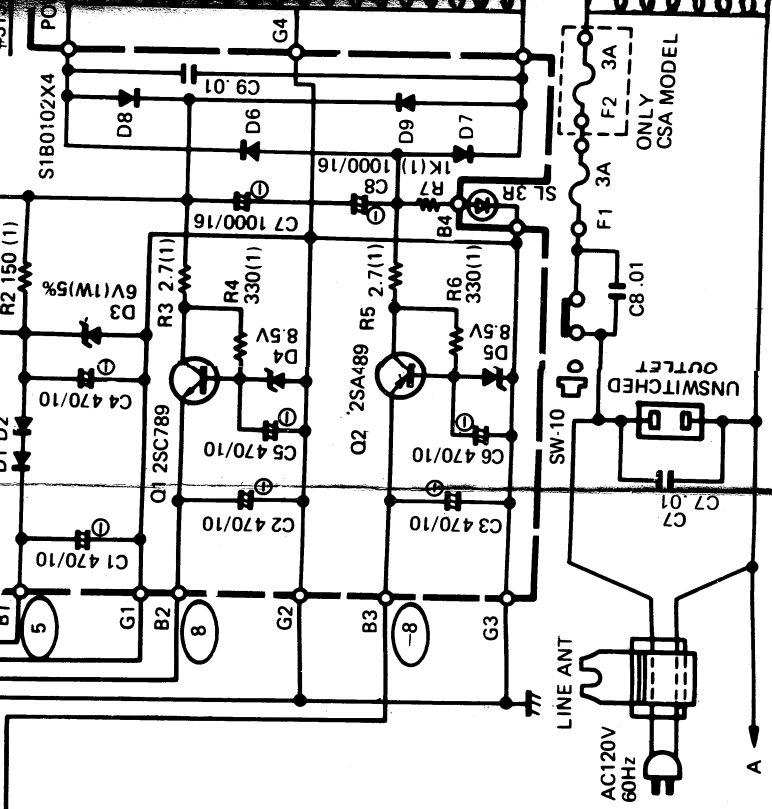
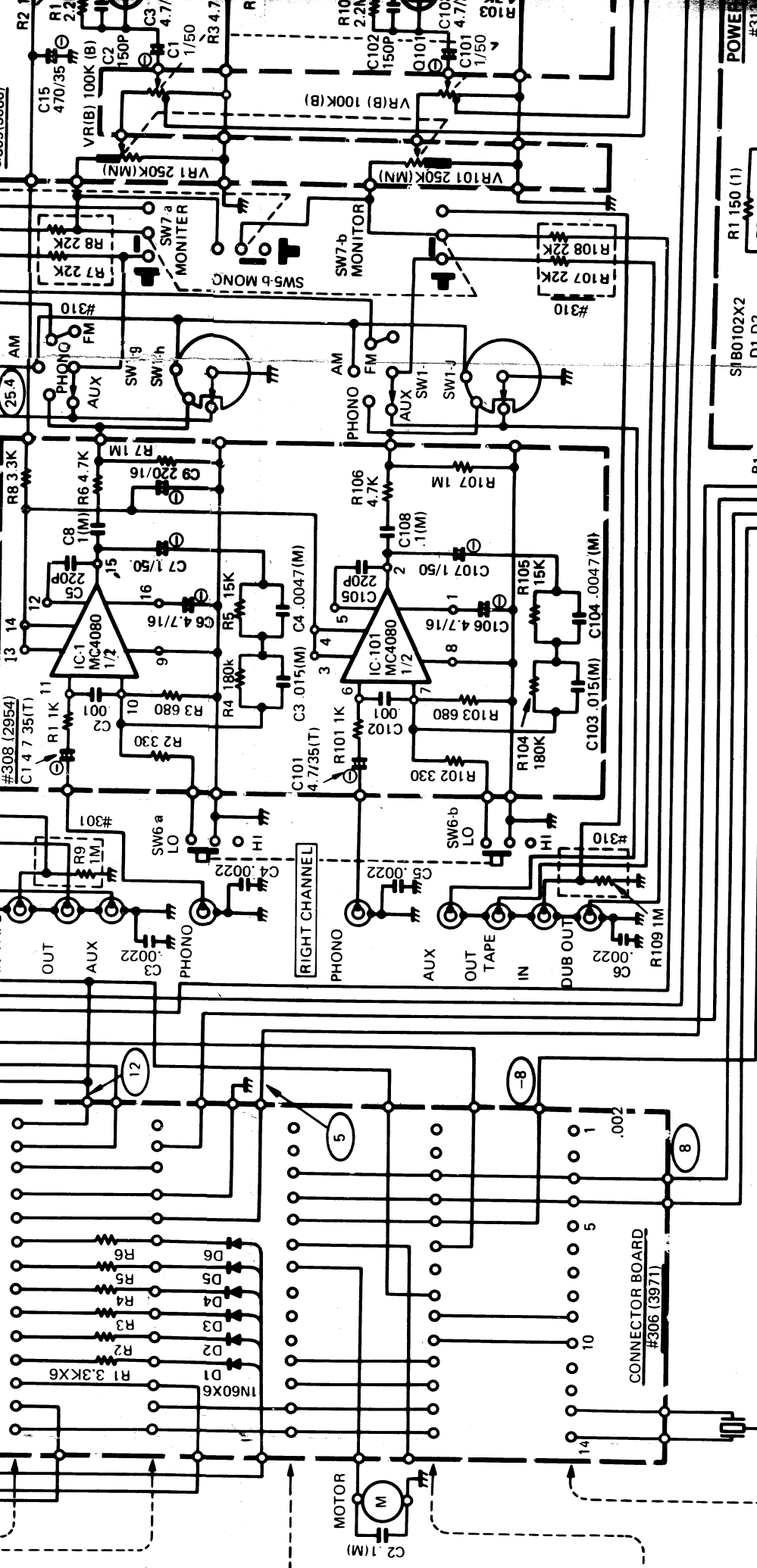
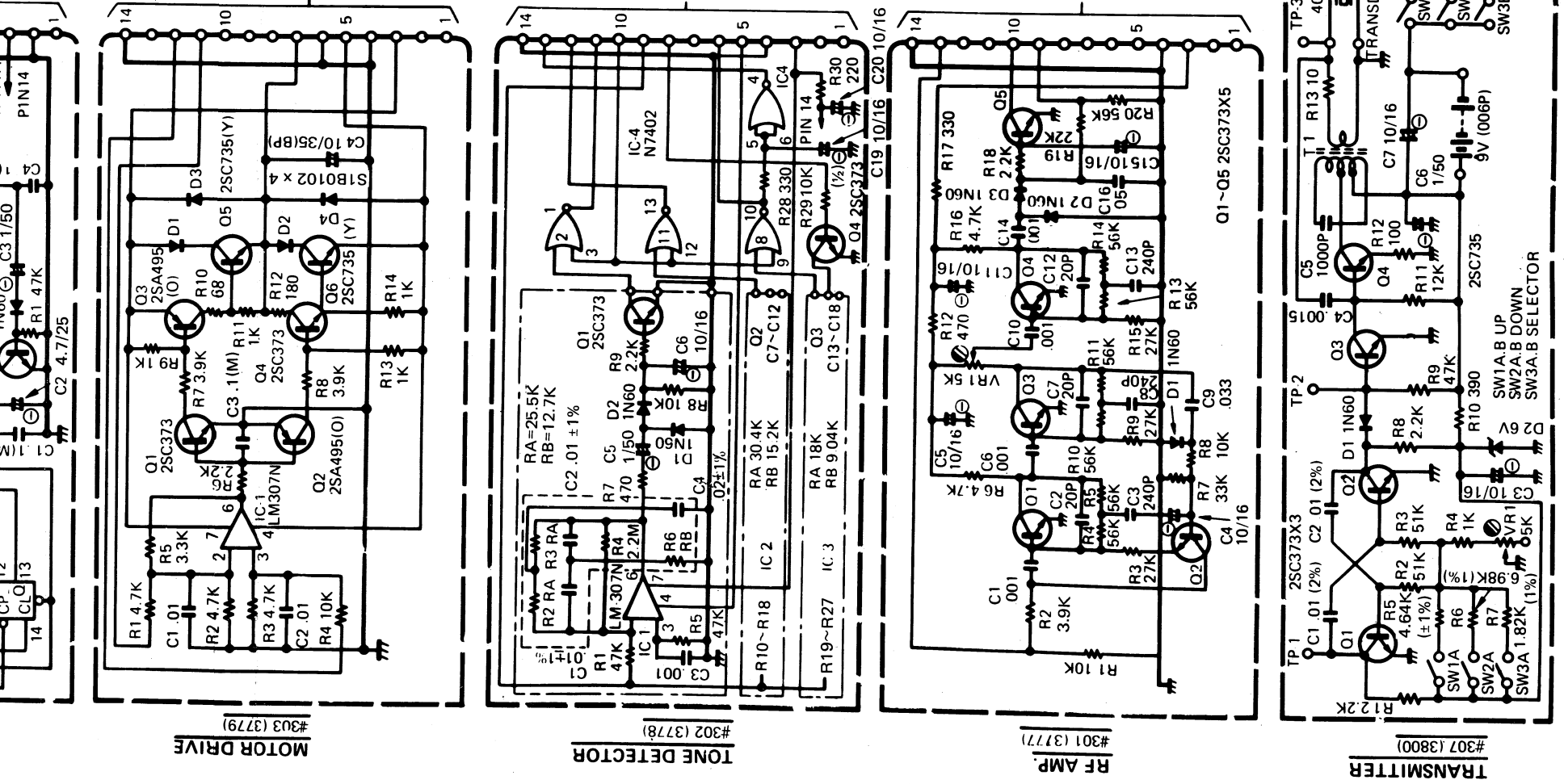

- NOTES:**
1. RESISTANCE VALUES ARE INDICATED IN OHMS UNLESS OTHERWISE SPECIFIED (K = 1,000 OHMS M = 1,000,000 OHMS).
 2. CAPACITANCE VALUES ARE SHOWN IN MICROFARADS UNLESS OTHERWISE STATED (P = MICRO-MICROFARADS). (M) = MYLAR CAPACITORS.
 3. RATING OR TYPE NUMBER OF COMPONENT PARTS ARE SUBJECT TO CHANGE FOR IMPROVEMENT WITHOUT NOTICE
- SW1a-j** SELECTOR SWITCH (AUX.PHONO.AM.FM REM.FM)
- SW2A-G** PRESETTER MANUAL SWITCH
- SW3** A.F.C.
- SW4** MUTE
- SW5** MONO
- SW7a-b** TAPE MONITOR
- SW8a-b** HI FILTER
- SW10** POWER
- SW12** LOUDNESS
- SW13** SPEAKER-A
- SW14** SPEAKER-B
- VR1, 101** BALANCE
- VR2, 102** TREBLE
- VR3, 103** MIDRANGE
- VR4, 104** BASS
- 4. SWITCH POSITION**
- OFF
- ON
- 5. INDICATES VOLTAGE READINGS FROM THE POINT INDICATED TO CHASSIS GROUND WITH V.T.V.M. UNDER THE POINT.**
- 6. F1: 2.5A FOR CSA MODEL**
- F2, F3, F4 CSA MODEL**

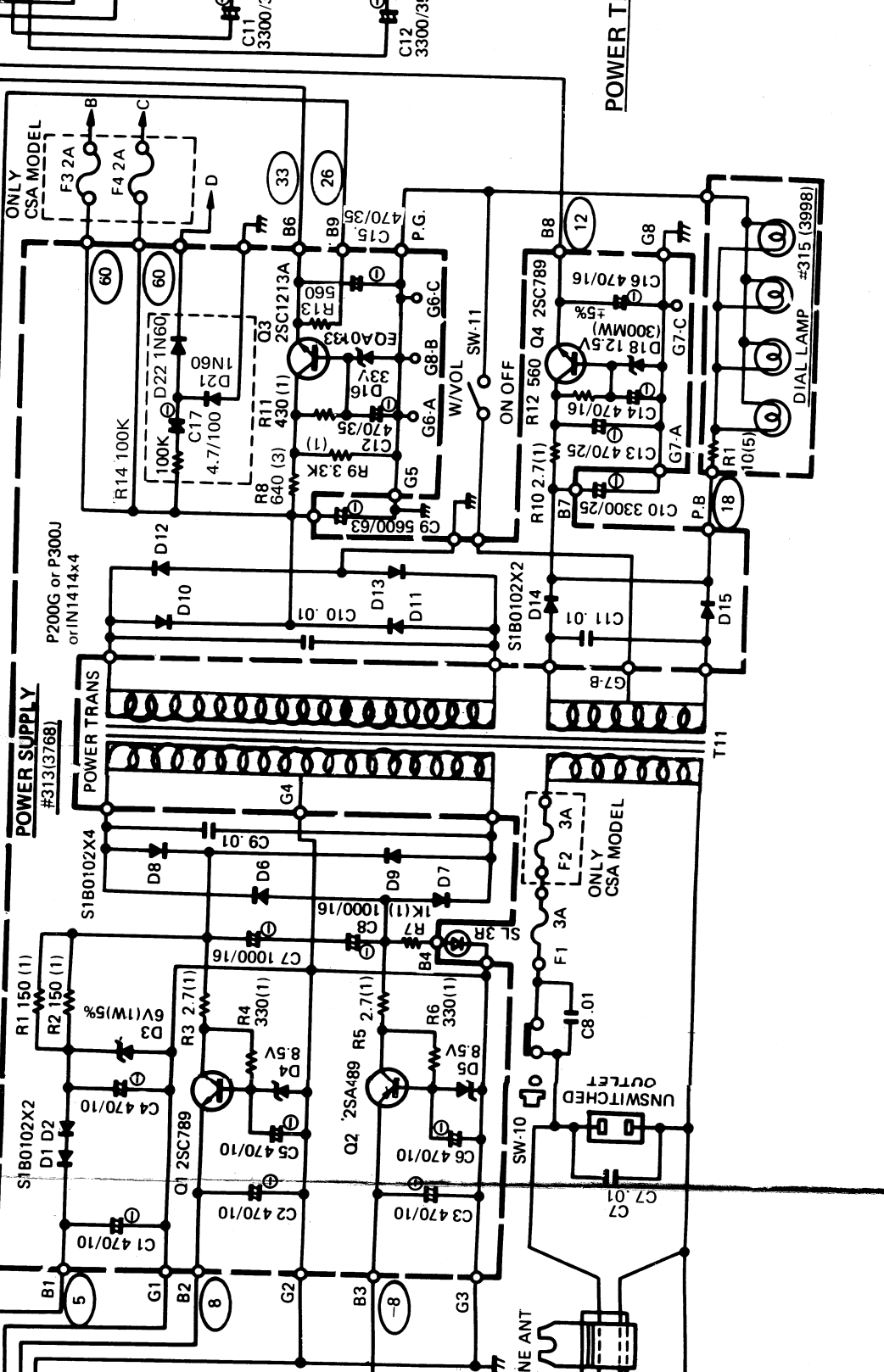
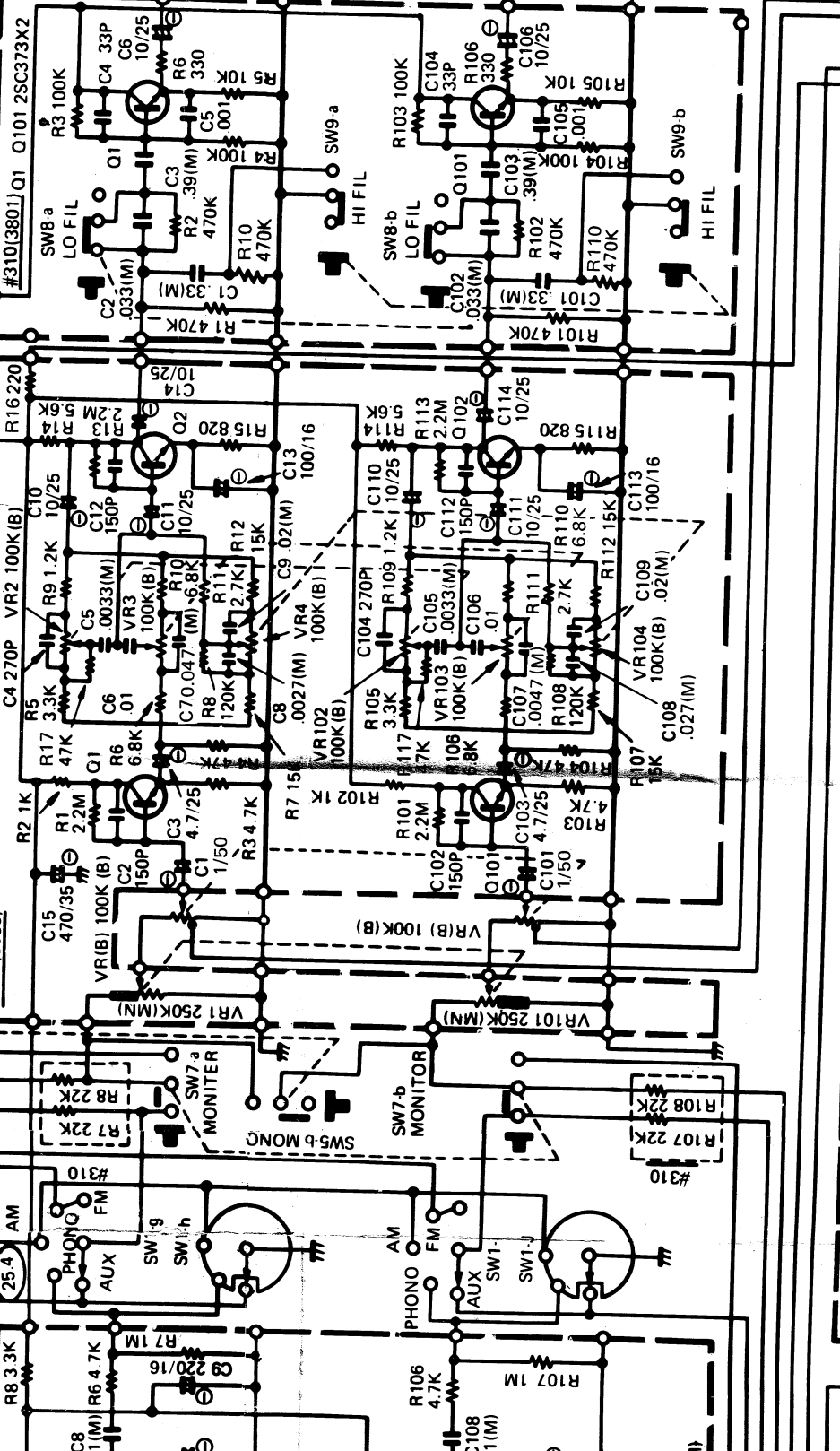
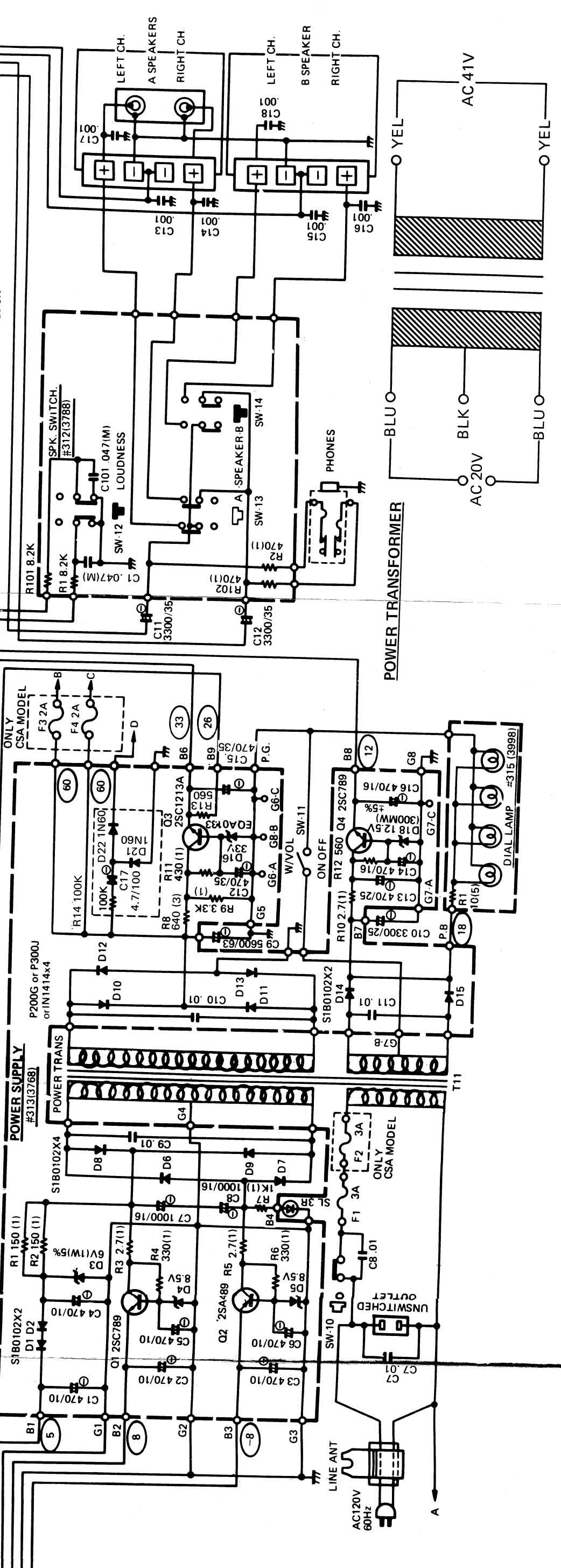
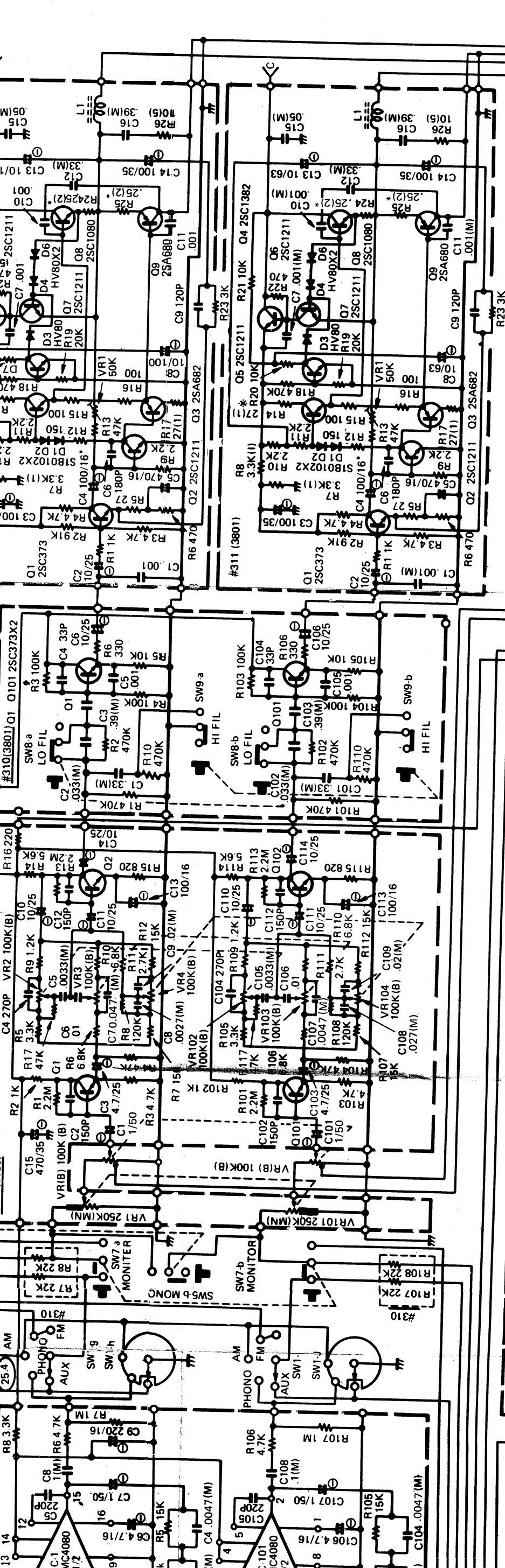

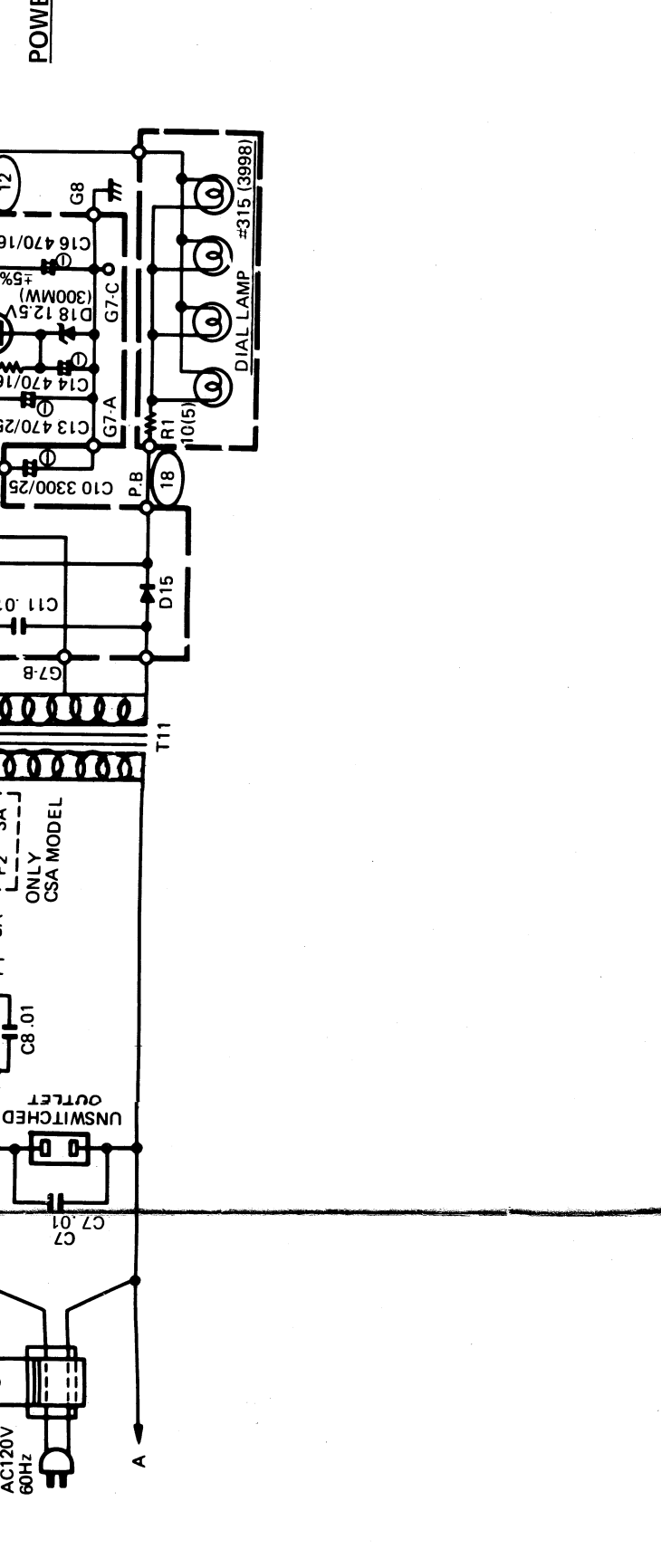
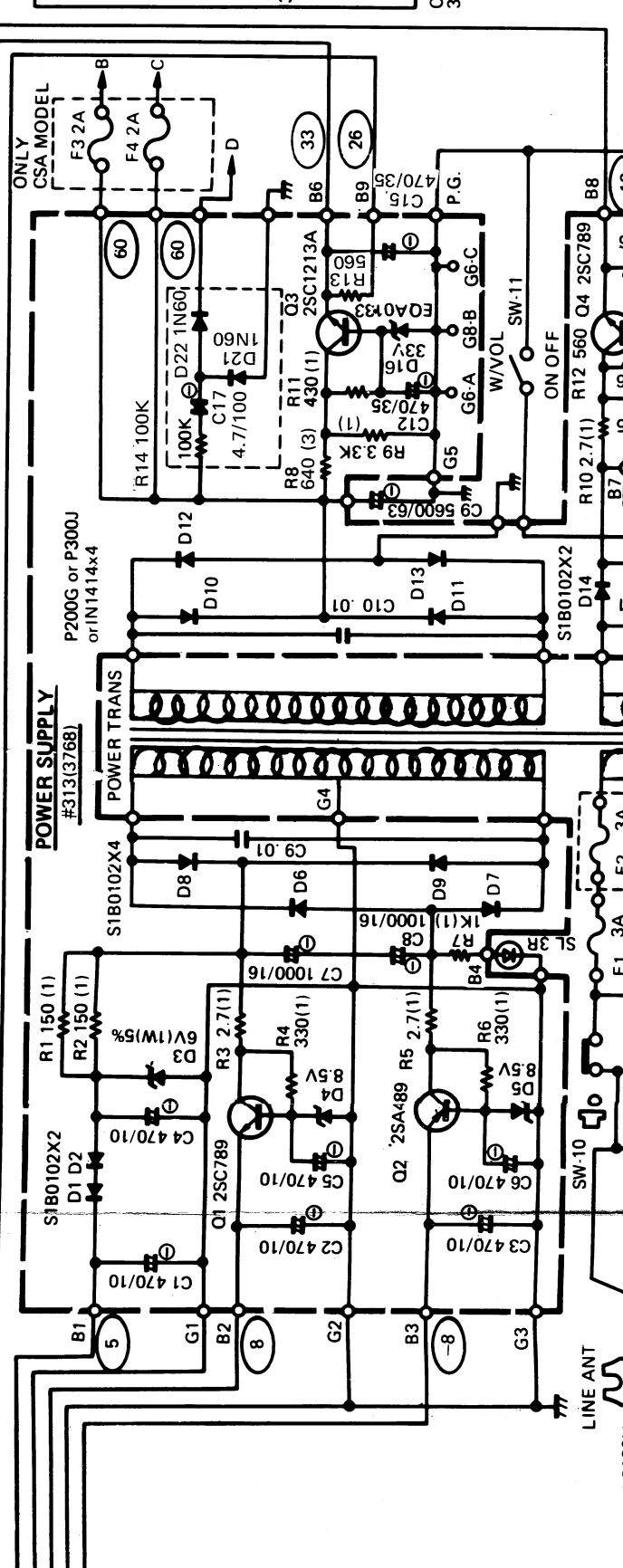
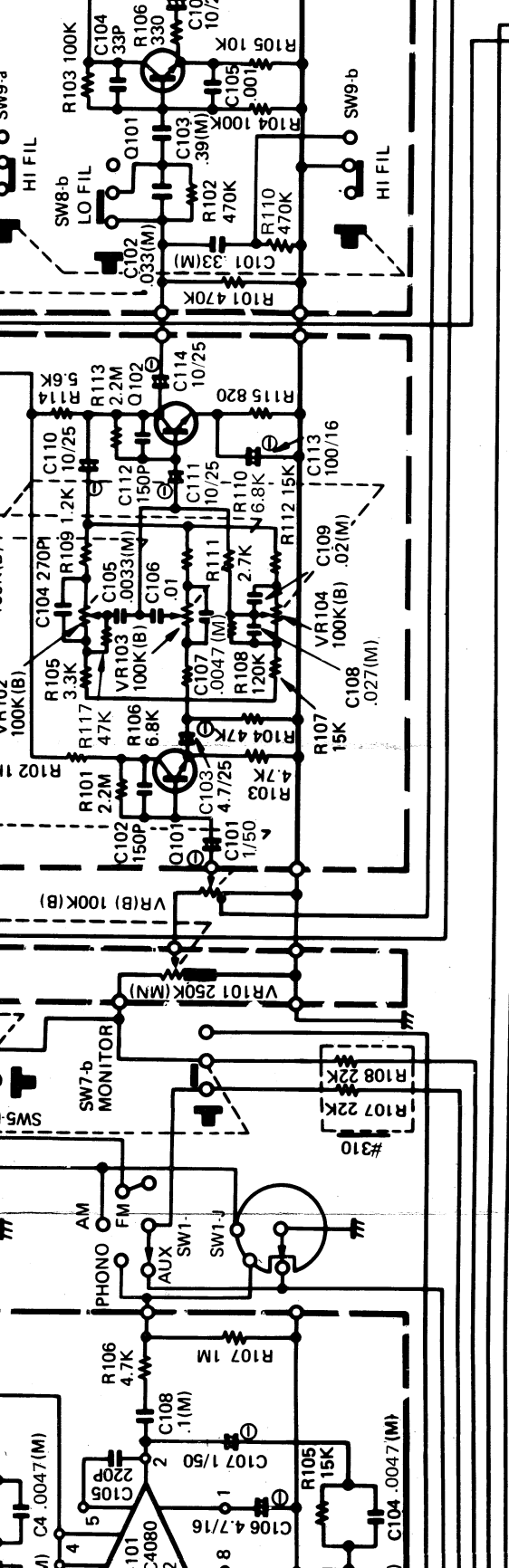
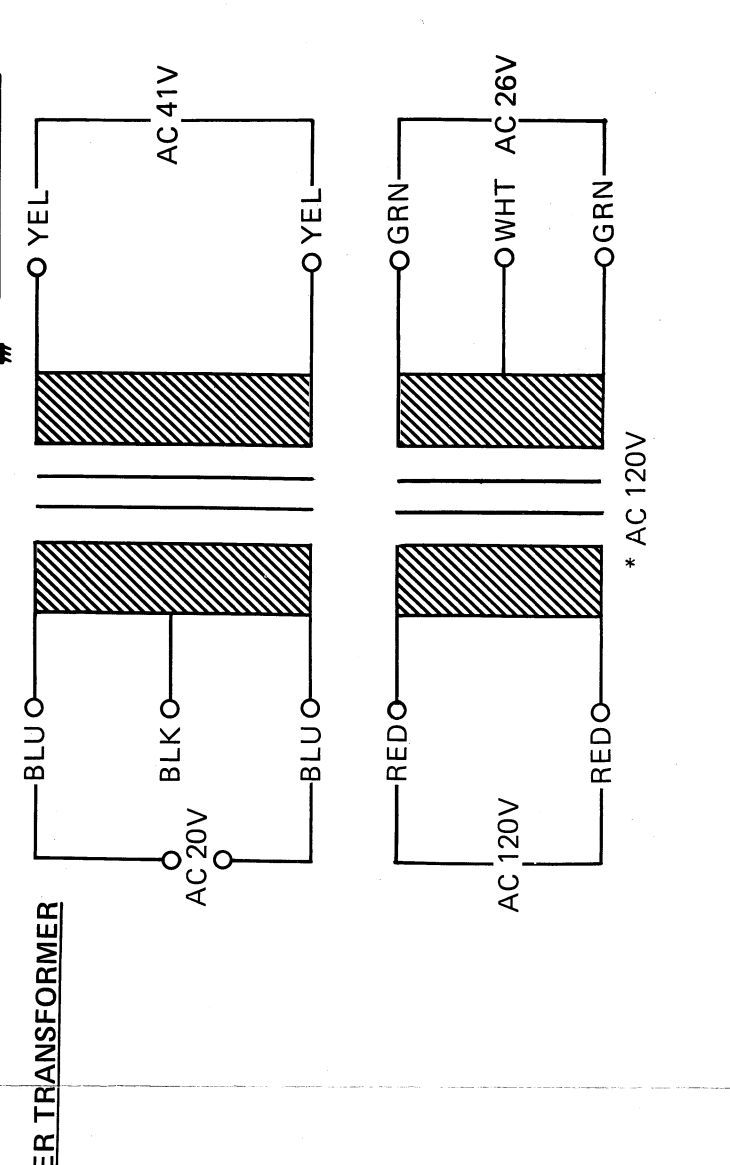
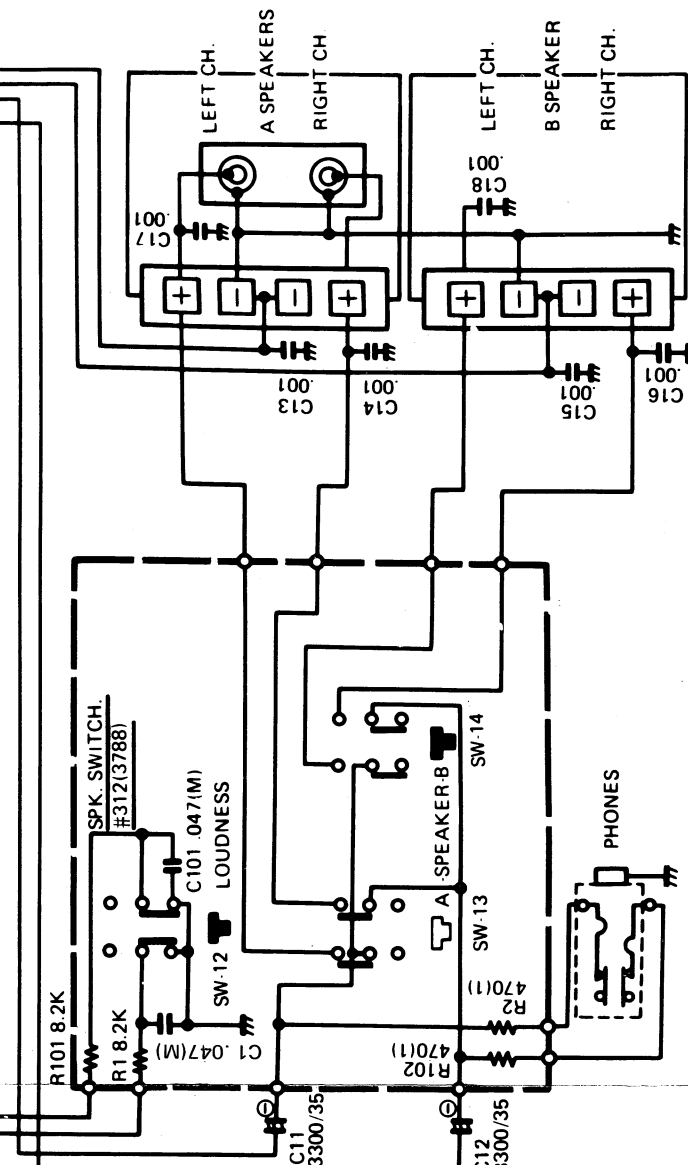
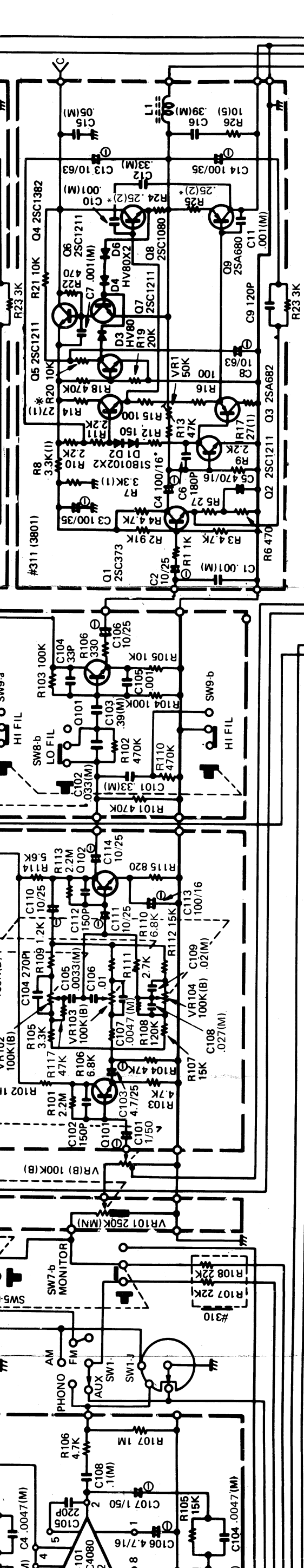

* AC 120V